



105 Bonnie Drive  
Butler, PA 16002  
724-283-4681  
724-283-5939 (fax)  
www.bwieagle.com

# PRODUCT INFORMATION BULLETIN

## AIR-EAGLE® XLT Analog & Digital 900 MHz RF Transmitter MODEL 44AN/D-1000-DC

### DESCRIPTION

The AIR-EAGLE XLT, MODEL 44AN/D-1000-DC is an RF transmitter capable of transmitting one analog or voltage input signal and one dry-contact input signal to an analog / digital output receiver. The transmitter and receiver combine to create a long range radio frequency system that monitors and operates hazardous or hard-to-reach electrical apparatus from safe, convenient locations of up to 2500 feet away. (Or longer with optional antennas) This unit is user-programmable for up to seven network frequencies to allow multiple systems to operate simultaneously in the same area without interference.

### INSTALLATION

1. Mount the AIR-EAGLE XLT TRANSMITTER in a convenient location
2. Install wiring to input terminal strip and select input type by setting dip switches 1 and 2 on SEL1 (see INPUT OPTIONS)
3. Install antenna onto TNC connector on side of unit.
4. Connect DC power to the proper terminals in your control circuit.

### TERMINAL STRIP WIRING

TER2 (LEFT BLOCK)				TER1 (RIGHT BLOCK)			
1	2	3	4	1	2	3	4
Dry-Contact – Common	Dry-Contact – N/O	(+) 9-36VDC Input	(-) 9-36VDC Input	Analog In (-)	Analog In (+)	(+) 12VDC	Open Drain Output (not used)

**Note #1** – **Input type MUST be selected** for the terminal strip wiring to take effect! (See INPUT OPTIONS & FREQUENCY SET-UP)

**Note #2** – When using in 4-20mA mode or voltage mode connect input to TER1, Pins 1 and 2 – be sure to observe polarity

**Note #3** – You can use a 12V loop powered 4-20mA sensor by connecting the (-) side to TER1, Pin 2 and (+) side to TER1, Pin 3. (use 12V powered sensor only – see wiring picture)

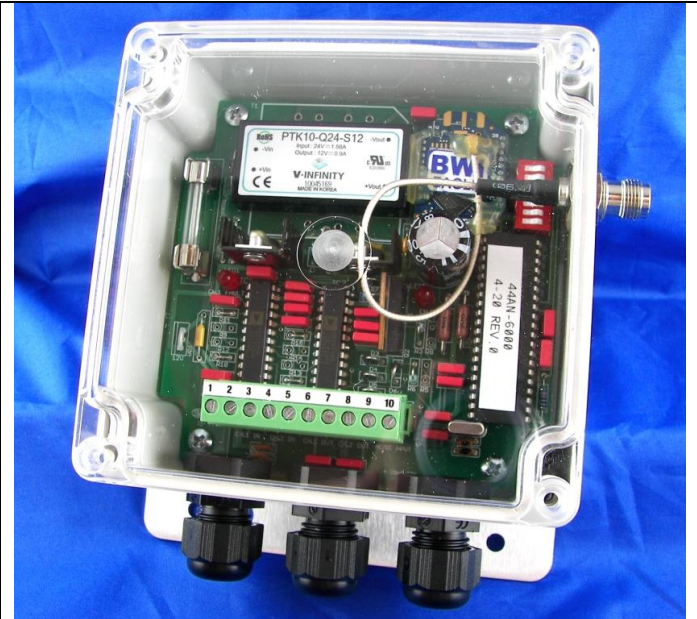
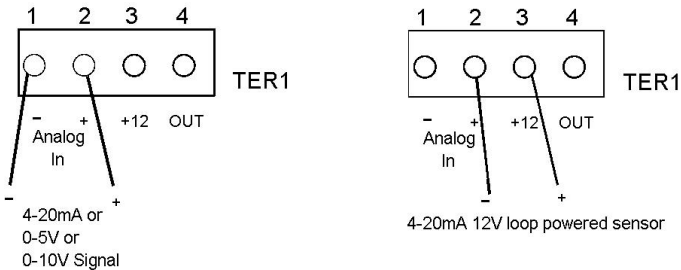

(Similar Model Pictured)  
Dimensions (with mounting plate) 6.3" L x 4.8" W x 2.3" H

### CONTROLS & INDICATORS

<b>POWER/TX LED</b>	Illuminates GREEN when powered on – Changes to RED when transmitting digital data
<b>INPUT FAULT LED</b>	Used in 4-20mA mode only – Illuminates RED when current loop open

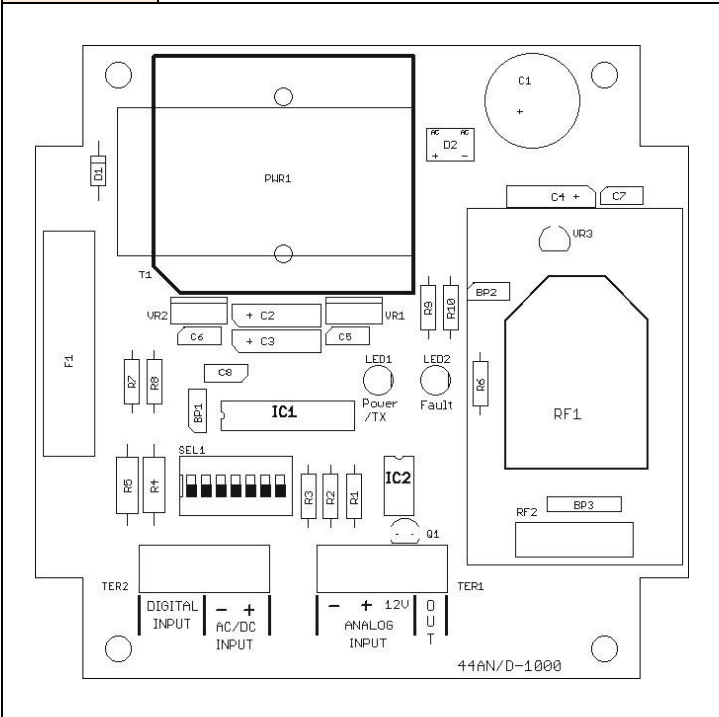

# AIR-EAGLE® XLT

## Analog & Digital 900 MHz RF Transmitter

### MODEL 44AN/D-1000-DC

### INPUT OPTIONS & FREQUENCY SET-UP

This transmitter is factory set with no input type selected and to operate on frequency #1. If you wish to change the default settings, follow the instructions using the table below:

- 1) Remove power from unit
- 2) Remove top cover.
- 3) Select desired input option and/or frequency using table below.
- 4) Reattach cover and apply power.
- 5) Programming is now complete.

INPUT CONFIGURATION					
		INPUT TYPE	SW1	SW2	
SEL1 SW1 & 2		No Input Selected <span style="color: red;">(default)</span>	OPEN	OPEN	
		4-20mA Input	CLOSED	OPEN	
		0-5VDC Input	CLOSED	CLOSED	
		0-10VDC Input	OPEN	CLOSED	
SW3 & 4		Reserved for future use			
FREQUENCY SET-UP					
		Network Frequency	SW5	SW6	SW7
SEL1 (SW5-7)		1 <span style="color: red;">(default)</span>	OPEN	OPEN	OPEN
		2	CLOSED	OPEN	OPEN
		3	OPEN	CLOSED	OPEN
		4	CLOSED	CLOSED	OPEN
		5	OPEN	OPEN	CLOSED
		6	CLOSED	OPEN	CLOSED
		7	OPEN	CLOSED	CLOSED

### APPROVALS

United States (FCC)	MCQ-XBPS3B
Canada (IC)	1846A-XBPS3B

### SPECIFICATIONS

Inputs	One 4-20mA or voltage input ( 0-5 or 0-10VDC) One dry-contact input
Fuse Protected	2 amp slow-blow
Update Time	4 samples / second
DC Input	9 – 36 VDC @ 10 Watts Fuse Protected – 1A Slo-Blo
Enclosure	Polycarbonate NEMA 4 (IP66)
Frequency	900MHz Spread Spectrum 7 Independent Networks
RF Output Power	250 mW
Transmit Range	Approximately 2500 Feet w/standard antenna
Operating Temperature	-40° F to +185° F

### REPLACEMENT PARTS & ACCESSORIES

PC Board (Main)	44AN/D-1002-DC
Standard Antenna (Included):	
900MHz Portable Antenna (For distances up to 2500 feet*)	49-1103
Optional Antennas and Accessories:	
900MHz Omni Directional Antenna (For distances up to 2 miles*)	49-3101
900MHz 13dB Yagi Antenna Long Range Operation (For distances up to 4 miles*)	49-3102
Flex Coax Cable w/Connectors	49-4000-XX (XX = # of Feet)
* = Line of Sight	

### LIMITED WARRANTY STATEMENT

BWI Eagle Inc. warrants the Air-Eagle Remote Control System, if properly used and installed, will be free from defects in material and workmanship for a period of 1 year after date of purchase. Said warranty to include the repair or replacement of defective equipment. This warranty does not cover damage due to external causes, including accident, problems with electrical power, usage not in accordance with product instructions, misuse, neglect, alteration, repair, improper installation, or improper testing. This limited warranty, and any implied warranties that may exist under state law, apply only to the original purchaser of the equipment, and last only for as long as such purchaser continues to own the equipment. This warranty replaces all other warranties, express or implied including, but not limited to, the implied warranties or merchantability and fitness for a particular purpose. BWI Eagle makes no express warranties beyond those stated here. BWI disclaims without limitation, implied warranties of merchantability and fitness for a particular purpose. Some jurisdictions do not allow the exclusion of implied warranties so this limitation may not apply to you. To obtain warranty service, contact BWI Eagle for a return material authorization. When returning equipment to BWI Eagle, the customer assumes the risk of damage or loss during shipping and is responsible for the shipping costs incurred.

DOCUMENT DATE: 1/24/18 / PRODUCT REV.1



105 Bonnie Drive  
Butler, PA 16002  
(724) 283-4681  
Fax (724) 283-5939  
[www.bwieagle.com](http://www.bwieagle.com)